

hope

COMMUNITY  
CHURCH

BUILDING  
PROJECT

**OFFER HOPE**

**GROW IN COMMUNITY**

**BE THE CHURCH**

# HISTORY & VISION

IN 2011, ABOUT 40 ADVENTUROUS SAINTS STEPPED OUT IN FAITH AND OFFICIALLY BEGAN SERVICES FOR HOPE COMMUNITY CHURCH. OVER THESE PAST 15 YEARS, WE HAVE USED WILSON SCHOOL AS OUR HOME, PULLING IN TRAILERS EVERY SUNDAY AND DOING MINISTRY DURING THE WEEK IN MANY DIFFERENT PLACES. GOD HAS USED HOPE TO PLANT CHURCHES, SEND MISSIONARIES, BUILD CHURCHES & SCHOOLS AROUND THE WORLD, BAPTIZE NEW BELIEVERS, AND EDIFY THE BODY OF CHRIST. OUR GOD IS AMAZING!

FAST FORWARD TO 2026! GOD HAS NOW PROVIDED US WITH 5.5 ACRES ON OVERTON ROAD WITH FACILITIES FOR MINISTRY AND OFFICES. ALONGSIDE THESE EXISTING USEFUL SPACES, WE NOW PLAN TO BUILD A WORSHIP CENTER, HOPEKIDS WING, AN OUTDOOR COURTYARD, AND AN EXPANDED PARKING LOT!

MAY GOD CONTINUE TO USE HOPE TO BE A LIGHT TO THE SURROUNDING COMMUNITY, PLANT MORE CHURCHES, SEND MORE MISSIONARIES, BUILD MORE SCHOOLS AND CHURCHES AROUND THE WORLD, BAPTIZE NEW BELIEVERS, AND GROW SPIRITUALLY IN COMMUNITY AS THE CHURCH IS EDIFIED.

# PROJECT DETAILS

ADDITION OF ~17,000 SQ FT TO EXISTING FACILITIES

650 SEAT MULTI-PURPOSE WORSHIP CENTER FOR PREACHING GOD'S WORD, WORSHIP, CONFERENCES, ETC.

SPACIOUS LOBBY FOR HOPECENTRAL, HOPEKIDS CHECK-IN, HOSPITALITY, A NURSING ROOM, AND SEVERAL STORAGE SPACES.

SECURED AREA FOR HOPEKIDS, DESIGNED FOR SUNDAY MORNING AND WEDNESDAY NIGHT AWANA, WITH DEVOTED BATHROOMS FOR THE KIDS AND AN OUTDOOR PLAYGROUND.

COURTYARD DESIGNED FOR FELLOWSHIP WITH SHADE STRUCTURES, TREES, SITTING AREAS AND OUTDOOR EVENT SPACE.

WE ARE BUILDING THIS SPACE TO ENCOURAGE RELATIONSHIP!

ESTIMATED 18-MONTH BUILD TIME STARTING ON JULY 1<sup>ST</sup>

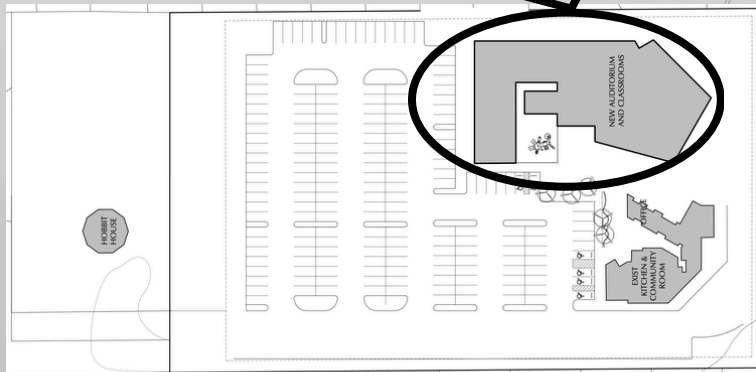
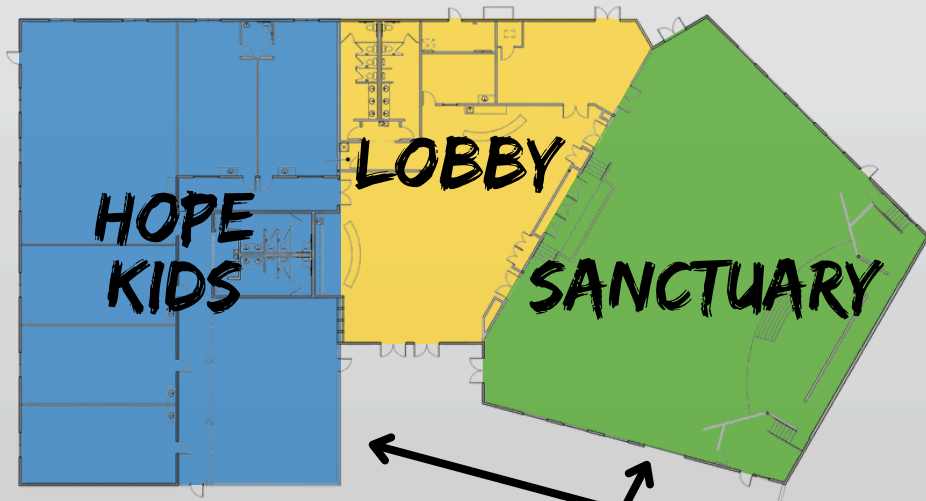

# GIVING TO DATE

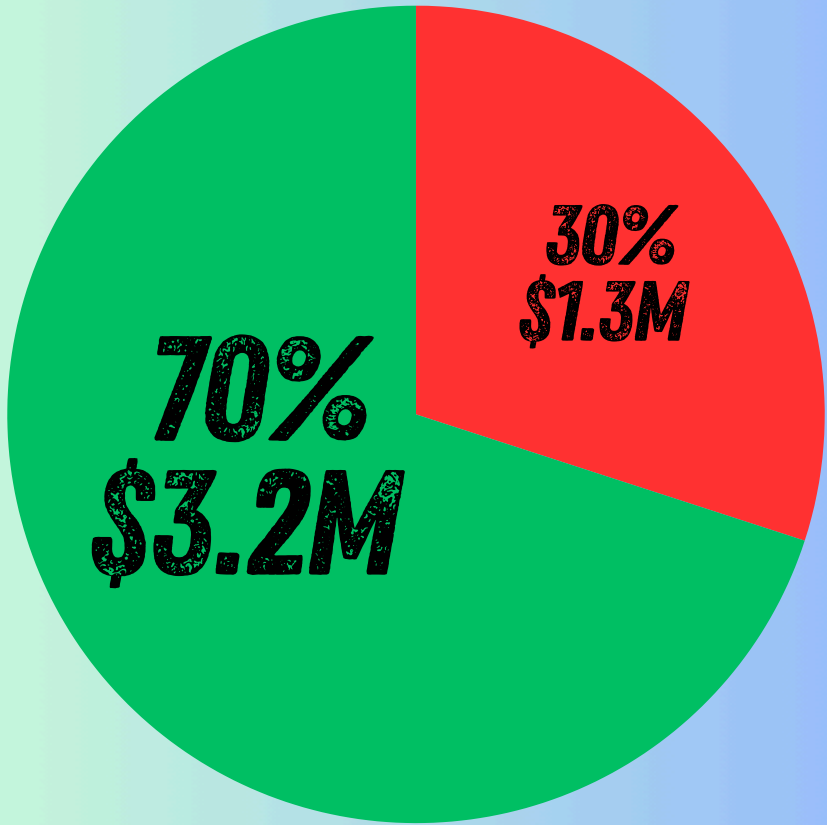

# FINANCIALS

"FINAL PUSH"  
NOW UNTIL END OF 2026

WITH THE AIM OF GETTING ACROSS  
THE FINISH LINE FINANCIALLY, WE  
WOULD LOVE TO RAISE AT LEAST  
\$1.3 MILLION THROUGH THE END OF  
THE YEAR

OUR TEAM IS ALSO RESEARCHING  
FINANCING OPTIONS (IF NEEDED)  
AND PLANNING FOR COST  
CONTINGENCIES



# GIVING

**"NOT THAT I DESIRE YOUR GIFTS; WHAT I DESIRE IS THAT MORE BE CREDITED TO YOUR ACCOUNT."  
PHILIPPIANS 4:17**

**PAUL TOLD THE CHURCH IN PHILIPPI, THAT GIVING TO MINISTRY AND KINGDOM WORK IS AN OPPORTUNITY TO ADD TO YOUR ACCOUNT WITH THE LORD. GOD IS AFTER THIS IN ALL OF US, WHETHER WE ARE RICH OR POOR, AND WITH HIM THE GIFT IS ACCEPTABLE ACCORDING TO WHAT WE ARE ABLE TO CONTRIBUTE NO MATTER THE SIZE (2 CORINTHIANS 8:12)**

**MAY GOD BLESS YOU IN YOUR GIVING!**

## IDEAS

- GIVE UP SOMETHING AND SET ASIDE THAT AMOUNT
- PRAY WITH YOUR FAMILY AND STEP OUT IN FAITH
- SELL A CAR/BOAT
- DO A YARD SALE AS A HOME-GROUP
- INVOLVE YOUR KIDS IN A WAY TO RAISE MONEY
- GIVE PART OF A SAVINGS ACCOUNT
- PLEDGE A PERCENTAGE OF YOUR WEEKLY SALARY





# PRAYER

- PRAY OVER 2 CORINTHIANS 8:1-15 PERSONALLY
- PRAY THAT GOD WOULD PROVIDE SO THAT WE COULD DO THIS WITH CASH AND WOULDN'T NEED FINANCING FOR THE FINAL GAP
- PRAY THAT GOD WOULD TOUCH THE HEART OF SUB-CONTRACTORS TO GIVE US AMAZING BIDS
- PRAY THAT GOD'S SKILLED BUILDERS WOULD RISE TO OFFER THEIR SERVICES (MANY ALREADY HAVE)
- PRAY FOR SAFETY AND PROTECTION OVER THE WORKERS
- PRAY THAT GOD WOULD ALLOW THE BUILDING TO GO UP WITH SPEED SO THAT VERY SOON WE COULD OFFER HOPE, GROW IN COMMUNITY, AND BE THE CHURCH RIGHT THERE ON OVERTON ROAD

# hope

COMMUNITY  
CHURCH

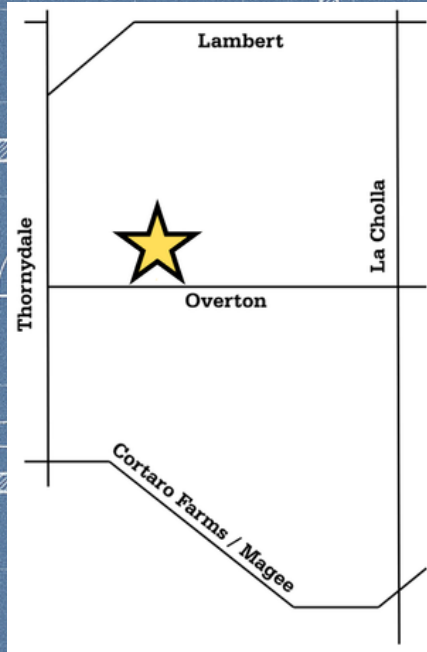

**OFFER HOPE**

**GROW IN COMMUNITY**

**BE THE CHURCH**

**Hope Community Church**  
**3130 W Overton Road, Tucson, AZ 85742**  
**[building@hopetucson.com](mailto:building@hopetucson.com)**