

File Name: A2-FLRPLN
 Plot Date: 08/22/97
 Plot Time:

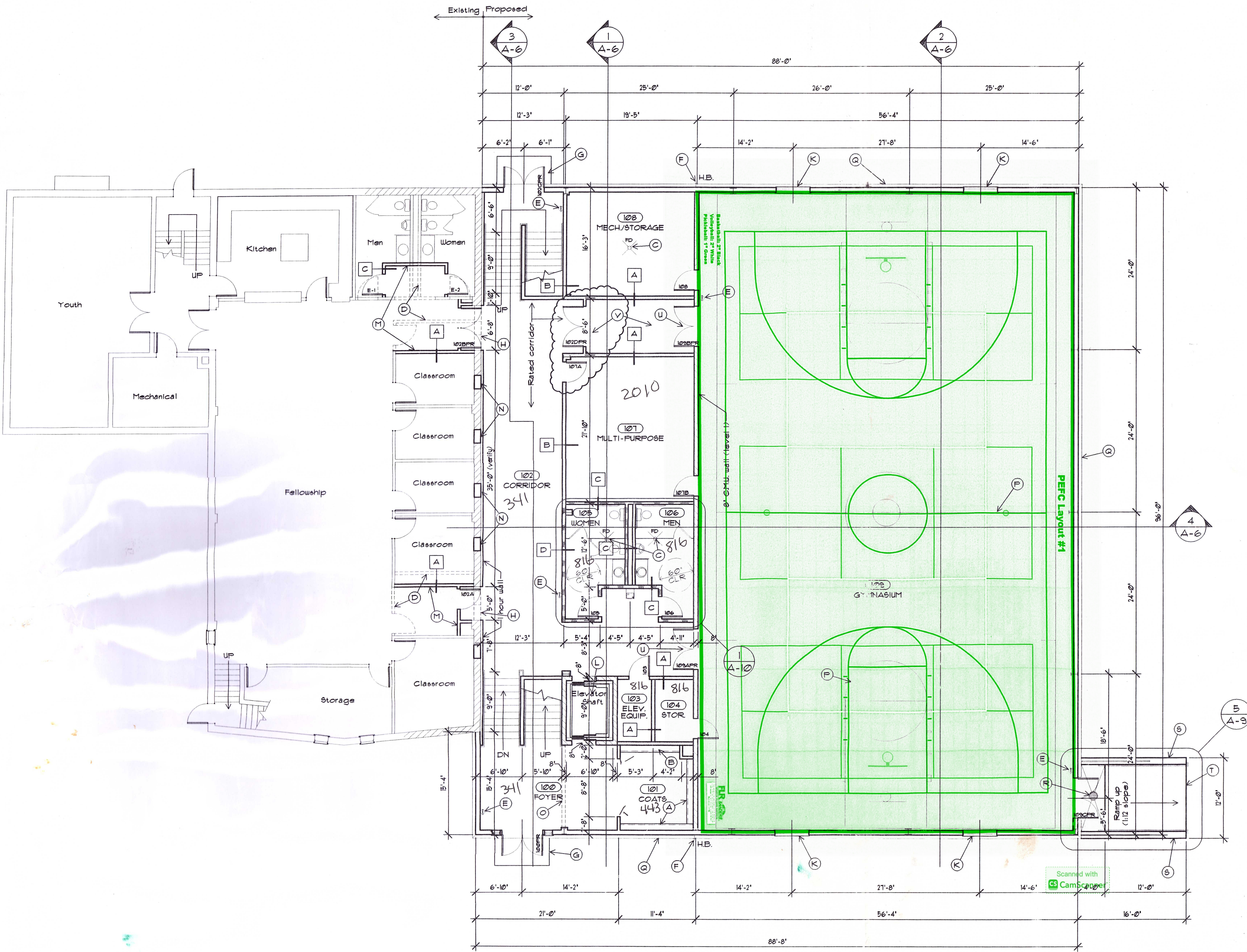

GENERAL NOTES:

General contractor shall verify all dimensions and conditions at the site and report any discrepancies to the architect prior to the start of any work.

Verify all slab elevations and depressions required by floor finish schedule, sections and details.

Do not scale drawings for building purposes, use plan information, dimensions, details, shop drawings and field verification.

Cross reference architectural drawings with structural, mechanical and electrical drawings to assure coordination of locations, sizes, materials and code compliance.

All interior dimensions to centerline of wall unless noted otherwise.

All exterior dimensions to face of sheathing unless noted otherwise.

Interior signage per Minnesota accessibility code.

All structural steel framing to be fire protected by a sprayed on fire resistive coating or by enclosing all members with type 'X' gypsum to provide a 1 hour rating.

Building to have a manually operated fire alarm system with an approved prerecorded message announcement per U.F.C. 91 Sec. 14.104. System to have an approved emergency power source.

- PLAN NOTES:**
- (A) Rod 4 shelf (standard height)
 - (B) Rod 4 shelf (handicap accessible 48" high)
 - (C) Floor drain
 - (D) Existing walls to be removed
 - (E) Fire extinguisher - located every 15 lf. (verify locations with local fire marshal)
 - (F) Hose bib (2 exterior locations)
 - (G) 4'-0" concrete stoop (see structural dugs)
 - (H) Cut opening in existing cmu wall (see structural dugs)
 - (J) Add wire glass to existing windows to provide 20 min. rating
 - (K) Windows - 5'-0"x4'-0" (20 s.f. min) white vinyl slider unit with double glazed low E argon filled glass
 - (L) Elevator - 3 stop handicap accessible passenger elevator. (verify size and installation requirements with supplier, elevator shaft to be pressurized per UBC 1994 section 104.22)
 - (M) New wood framed walls to provide connection to new addition
 - (N) Fill in existing window openings with 2"x framing and 5/8" type 'X' gypsum both sides
 - (O) Suspended wall above, separating gyp ceiling from suspended ceiling
 - (P) Gymnasium floor striping by owner
 - (Q) Top course cmu with chamfer
 - (R) Catch basin (tie into drain tile system)
 - (S) 12" cmu retaining walls (see structural dugs)
 - (T) 4" concrete ramp
 - (U) Room capacity to be posted at 358.
 - (V) Area of Refuge. (Provide signage stating that this is an 'Area of Refuge')

- LEGEND:**
- ==== 2"x stud wall
 - ==== cmu wall
 - ⊙ NAME Room reference symbol
 - ⊙ Detail reference symbol
 - ⊙ Section reference symbol
 - ⊙ Elevation reference symbol
 - A Wall type reference symbol

TYPICAL INSULATION VALUES:

Roof system - R-30
 Walls system - R-19
 Foundation system - R-10

LOWER LEVEL FLOOR PLAN

1
A-2
1/8" = 1'-0"

GENESIS ARCH
 410 SW Becker Ave, PO
 Willmar, MN 56201
 Tel: (320) 235-8663
 Fax: (320) 235-8683

I hereby certify that this
 report was prepared
 under my direct supervision
 and I am a duly registered
 architect in the state of
 Minnesota.

Philip B. ...
 Date: 8-21-97 Reg. No. ...

TWC Worsh
 Preliminaries:

Revisions:
 08/22/97

Project Title: ...
 Architect: ...
 Engineer: ...
 Minnesota