

HARVEST NETWORK 2026 ANNUAL ASSEMBLY

CALLED
REKINDLE THE FLAME

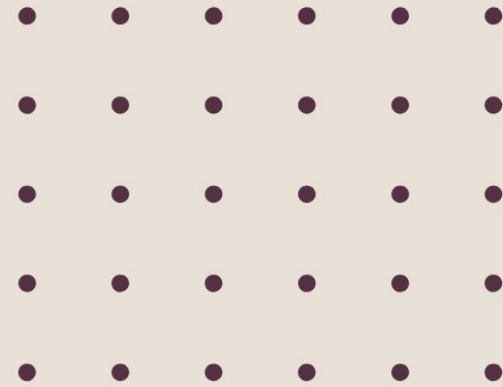

PRESENTERS

**Dale
Sisam**

Director of Harvest
Network International



**Crawford
Loritts**

President and Founder of
Beyond our Generation



JUNE 23-25, 2026

**SNELLVILLE COMMUNITY CHURCH
SNELLVILLE, GA**

HARVEST NETWORK INTERNATIONAL
P.O. BOX 157, DELAWARE, OH 43015
(651) 438-2596

harvestnetwork.live



Table of Contents



2026 HNI ANNUAL ASSEMBLY

FIND HELPFUL INFORMATION ONLINE

(Use these QR codes)



PACKET



FACILITY MAP



SCHEDULE

2	TABLE OF CONTENTS
3	WELCOME TO HARVEST NETWORK'S ANNUAL ASSEMBLY!
4-5	MAIN SESSION SPEAKERS
6	WORKSHOP DESCRIPTIONS
7	ASSEMBLY INFORMATION
<hr/>	
8-9	SESSION 1-NOTES
10-11	SESSION 2-NOTES
12	WORKSHOP 1-NOTES AT 11:00 AM-NOTES
13	WORKSHOP 2-NOTES AT 1:30 PM-NOTES
14-15	SESSION 3-NOTES
16-17	NEW INDIVIDUAL, INTERNATIONAL, & CHURCH MEMBERS
18-19	SESSION 4-NOTES
20-21	SESSION 5-NOTES
<hr/>	
22-23	ABOUT HARVEST NETWORK
24	REGIONAL CONNECTION
25	2027 ASSEMBLY EARLY REGISTRATION
26-28	HARVEST NETWORK RESOURCES
29	HARVEST NETWORK TRAINING
30	MINISTRY TRAINING SCHOOL PARTNERSHIPS
31	2025-2026 FINANCIALS
32	LOCAL SITES
33	LOCAL RESTAURANTS
34-35	FACILITY MAP (ANNUAL ASSEMBLY ONLINE SURVEY)
36	ASSEMBLY SCHEDULE

Welcome to the 2026 Annual Assembly!



Dale Sisam
HNI Network Director



Welcome to the 2026 Harvest Network Annual Assembly!

What a joy it is to gather together again as a family of leaders called by God to serve His Church and advance His mission.

Our theme this year is Called: Rekindle the Flame, anchored in 2 Timothy 1:6-7:

“For this reason I remind you to fan into flame the gift of God, which is in you...”

Ministry can sometimes cause that flame to flicker—but God’s call on your life has not changed. His Spirit is still at work, and His purpose still stands. This week is a sacred opportunity to be renewed, refreshed, and reignited in your calling.

As we gather, my prayer is simple: that God would rekindle the flame within you and strengthen you to walk fully in all He has called you to be and do.

Let’s lean in together with open hearts and expectant faith.

“Lord, rekindle the flame within me, that I may boldly live out Your call.”

For the harvest,

A handwritten signature in black ink, appearing to read "Dale Sisam".

Dale Sisam
HNI Network Director

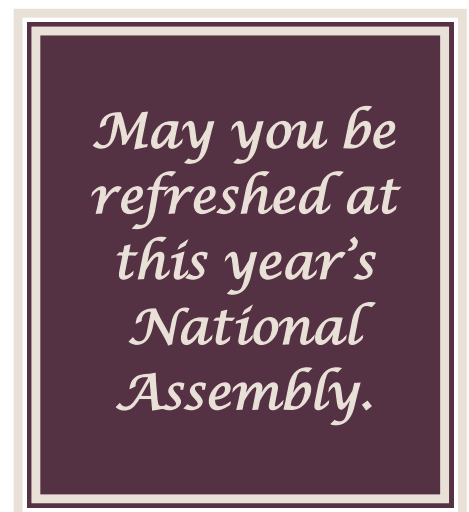

Main Session Speakers



Dale Sisam serves as the Network Director for Harvest Network. As a seasoned shepherd to the shepherds, his passion is to encourage and guide ministry leaders into healthy ministry. Dale holds an M.A. in Pastoral Ministry and also serves as North Regional Director for Standing Stone Ministry. Dale and his wife, Sandy, reside in the Twin Cities of Minnesota, have three adult children and enjoy being grandparents. You can learn more about Dale at standingstoneministry.org/shepherd/dale-sisam.



Crawford Loritts is the President and Founder of Beyond Our Generation and is committed to encouraging and helping to shape the next generation of Christian leaders. He graduated from Cairn University in 1972 with a Bachelor of Science degree in Bible. He has traveled throughout the US and much of the world, speaking in churches, evangelistic outreaches, conferences, colleges and seminaries. He has been the featured speaker at Super Bowls, NCAA Final Four Chapel and the Pentagon with senior military officers. He has been a church planter, served for 27 years on the staff of Cru (Campus Crusade for Christ) and served for 15 years as Sr. Pastor of Fellowship Bible Church, Roswell, GA. Crawford and Karen have been featured speakers at Family Life marriage conferences. Crawford is the author of 9 books including *Your Marriage Today... and Tomorrow*, co-authored with Karen. He is the host of two national radio programs, the weekend program Living a Legacy and the daily program Legacy Moments. Crawford has served on several boards including Passion, Cru, Family Life, Win Shape, and Chick-fil-a. He has received five honorary Doctorates (Biola Univ., Cairn Univ., Moody Bible Institute, Trinity International Univ. and Columbia International Univ.). Crawford and his wife, Karen, were married on May 22, 1971 and have 4 adult children and 11 grandchildren.



Dr. Quincy D. Brown is the Lead Pastor at Snellville Community Church in Snellville, GA. He is passionate about equipping God's people to imagine new ways to connect people with Jesus! Dr. Brown has served as the District Superintendent and Missional Strategist for the Central South District of the North Georgia Conference of the United Methodist Church. He is the author of *Discipleship Path: Guiding Congregations to Connect with Jesus*. Quincy was a Youth Minister, an Associate Pastor, a Chaplain and Vice President of LaGrange College, an Assistant Pastor, Church Planter, and an Executive Pastor. He graduated with a bachelors in Electronic Engineering Technology, and has graduated with an M. Div. and D. Min. He is married to Dionne Moore Brown. You can contact Quincy at qbrown@snellvillecc.org.



Tom Herbert is the Lead Pastor at Freedom Community Church in York County, PA, and also serves as the National Field Coordinator for Harvest Network International. He is passionate about equipping the saints for the work of ministry and coming alongside leaders to walk in their calling. Tom has been certified as a DCPI Trainer. He serves on the board for the York House of Prayer and he serves on the board for New Life Center For Mothers and Children. Tom and his wife, Judy, have four adult children and four grandchildren. You can contact Tom at therbert@calledtofreedom.org.



Sandy Sisam serves as the Northern Regional Director for Standing Stone Ministry. Her passion is to encourage pastors and leaders to flourish in health, healing, and wholeness. Sandy is a published author and has a Monday through Friday Defining Woman Rise and Thrive Facebook encouragement page for women. Sandy and her husband, Dale, have three adult children and eight grandchildren with number eight due in August. To learn more about Sandy's ministry or to contact her for speaking engagements, please email her at Sandra.S@standingstoneministry.org.

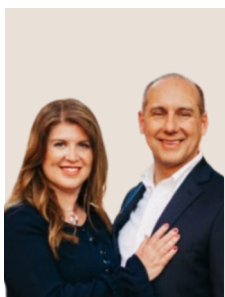

Jerry & Melanie Stone are Founders of Grow Churches. Together they work to train leaders and help plant churches, especially in the Middle East and North Africa region (MENA) of the 1040 Window. Jerry's experience includes planting churches and pastoring. He teaches in churches, Bible schools, conferences, and more. Melanie senses a call to write and create Christian resources to share freely on growchurches.com with Christians around the world. She is currently working to have these resources translated into other languages so the resources can be utilized in other nations. Melanie has a published book called "Open," a book about receiving from God. Jerry and Melanie graduated from Rhema Bible Training Center and Life Christian University. They were married in 1986 and have two daughters, a son-in-law, and several grandchildren. You can learn more about Jerry and Melanie at growchurches.com.

Workshop Descriptions

Wednesday, June 24—11:00 am-12:00 pm & 1:30-2:30 pm

(All workshops are offered at both times.)



HNI 101

Kevin Brown—Location: Rm. 207

HNI 101 is a workshop specifically for new members of HNI and people who are interested in learning more about our purpose, values, and benefits. If this is your first Assembly we encourage you to attend this workshop.



Workflows: Let Automation Take On Your Tasks so You Can Get Back to Ministry

James Seawell—Location: Rm. 318

In this session, you will learn how to transition your staff from administrative overload to relational ministry by leveraging the automation within Churchteams. We will dive deep into the workflow feature, demonstrating how to map out and automate repetitive tasks like guest follow-up, volunteer onboarding, and milestone recognition. By the end of the workshop, you'll have a practical blueprint for setting up systems that ensure no one in your community is overlooked. Ultimately, you'll discover how the right tech strategy creates the margin needed for the high-touch, personal care that your people deserve.

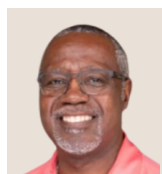

Roundabout Renewal

Dr. Quincy D. Brown—Location: Rm. 317

Faith leaders today are navigating significant transitions—changing communities, evolving ministry models, leadership fatigue, and the tension between honoring the past while discerning the future. Yet many leaders lack language for the season they are in. In this workshop, Quincy Brown introduces The Roundabout Way, a biblical and practical framework for understanding seasons of transition through five movements seen throughout Scripture: Egypt, Red Sea, Wilderness, Jordan, and Promised Land.



Closers & Losers: Leadership Pipeline Basics

Dennis & Dana Calhoun—Location: Rm. 210/211

Ministry leaders can learn how to become “closers” — leaders who close the gap and build a healthy leadership culture that attracts, develops, and retains great people — instead of “losers,” who unintentionally lose future leaders due to a lack of intentional development. Drawing from practical experience, the Calhouns will share simple tools and proven strategies for creating a leadership pipeline that moves people toward engaged ownership and long-term impact. Be a closer, not a loser!



Future Church Now

Tom Herbert—Location: Rm. 209

Designed for existing pastors and those considering church planting, this workshop unpacks the strategic models and biblical frameworks required to launch a healthy, multiplying church. Through our partnership with DCPI, Harvest Network is committed to training and equipping pastors and leaders to reach the world with the Gospel through church planting.



Onboarding New Members of the Body of Christ

Jim Anderson—Location: Rm. 319

When God brings either new converts or transferring believers to a local church, how can they be assimilated in a way that builds up the congregation's health and effectiveness? We will explore three steps in this process and recommend practical resources for your success.

Assembly Information



Welcome!

Welcome to the 2026 Annual Assembly. Our team is here to serve you. If you need assistance, find a team member wearing a blue T-Shirt that says “Here to Serve”.

Name Badges

We ask that all Assembly attendees wear their name badges at all times.

Information

If you need general information about the Assembly or need help in any way, please see one of our team members or stop by the HNI Resource Table in the Front—CLC Gymnasium.

QR Code

Use the QR codes to access pdfs of the handouts, maps, etc. The QR codes are located on page two and also on the backside of your name tag.

Assembly Recordings

Videos of the evening sessions will be available at a later date at harvestnetwork.live and on our harvestnetwork.tv. We are no longer downloading the sessions on a USB.

Ministry Display Tables

We encourage you to visit the display tables in the Front—CLC Gymnasium before and after the sessions. They provide materials from a variety of ministries and are a great way to connect with other ministries.

Connection Times

We have scheduled multiple opportunities for you to connect with others who are attending this event. Take time to meet new people and discover more about the vast ministry taking place in our network.

Wireless Internet

Wifi Username: SUMC Main
Password: Christ4u!

Shuttle Bus

A shuttle bus will run between the hotels (The Hampton Inn & The LaQuinta Inn) and Snellville Community Church during the Assembly. If you need transportation to the Hartsfield-Jackson Atlanta International Airport, please fill see Kellie Fellenger at the HNI Resource Table.

Shuttle Schedule

June 23:	9:30 pm
June 24:	8:15 am
	2:30 pm
	6:15 pm
	9:30 pm
June 25:	8:15 am



SNELLVILLE
COMMUNITY CHURCH

2428 Main St E
Snellville, GA 30078
snellvillecc.org
770-972-9360





Crawford Loritts

Session 1—Notes

Tuesday, June 23—7:00-8:45 pm—CLC Gymnasium

REMEMBER WHO YOU ARE



Session 1 (Additional Notes)





Dale Sísam

Session 2—Notes

Wednesday, June 24—9:30-10:00 am—CLC Gymnasium

THE COST OF THE CALL





Jerry & Melanie Stone

Session 2—Notes

Wednesday, June 24—10:00-10:30 am—CLC Gymnasium

YOU ARE CALLED

Romans 11:29 For the gifts and the **calling** of God are irrevocable.

Eph. 4:1 I, therefore, the prisoner of the Lord, beseech you to walk worthy of the **calling** with which you were called,

2 Tim. 1:9 who has saved us and called us with a **holy calling**, not according to our works, but according to His own purpose and grace which was given to us in Christ Jesus before time began.

Rom 8:27-31 vs. 28 to those who are the **called** according to His purpose. **vs. 30** these He also **called**; whom He called,

vs. 31 What then shall we say to these things? If God is for us, who can be against us?

Rom 1:1 Paul, a bondservant of Jesus Christ, **called** to be an apostle, separated to the gospel of God

1 Thes 5: 24 He who **calls** you is faithful, who also will do it.
 1. How tight right now are you holding on to your **calling**?
 2. Don't give up or eject "out" of your **calling**

Gal. 6:9 And let us not grow weary while doing good, for in due season we shall reap **if we do not lose heart.**

Remember 1 Thes 5:24 He who **calls** you is faithful, who also will do it.

2 Peter 1:10 Therefore, brethren, be even more diligent to make your **call** and election sure, for if you do these things you will **never** stumble; **say NEVER!**

Phil. 3:14 I **press** toward the goal for the prize of the upward **call** of God in Christ Jesus.

NOTES:

Workshop 1—Notes

Wednesday, June 24—11:00 am-12:00 pm
(All workshops are offered at both times.)



Kevin Brown
HNI 101
(Rm. 207)



James Seawell
WORKFLOWS: LET
AUTOMATION TAKE
ON YOUR TASKS SO
YOU CAN GET BACK
TO MINISTRY
(Rm. 318)



*Dr. Quincy D.
Brown*
ROUNDTABOUT
RENEWAL
(Rm. 317)



*Dennis & Dana
Calhoun*
CLOSERS & LOSERS:
LEADERSHIP
PIPELINE BASICS
(Rm. 210/211)



Tom Herbert
FUTURE CHURCH
NOW
(Rm. 209)



Jim Andreson
ONBOARDING NEW
MEMBERS OF THE
BODY OF CHRIST
(Rm. 319)



Workshop 2—Notes

Wednesday, June 24—1:30-2:30 pm

(All workshops are offered at both times.)



Kevin Brown
HNI 101
(Rm. 207)



James Seawell
WORKFLOWS: LET
AUTOMATION TAKE
ON YOUR TASKS SO
YOU CAN GET BACK
TO MINISTRY
(Rm. 318)

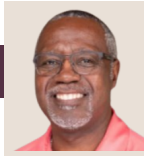

*Dr. Quincy D.
Brown*
ROUNDAABOUT
RENEWAL
(Rm. 317)



*Dennis & Dana
Calhoun*
CLOSERS & LOSERS:
LEADERSHIP
PIPELINE BASICS
(Rm. 210/211)



Tom Herbert
FUTURE CHURCH
NOW
(Rm. 209)



Jim Anderson
ONBOARDING NEW
MEMBERS OF THE
BODY OF CHRIST
(Rm. 319)





Crawford Loritts

Session 3—Notes

Wednesday, June 24—7:00-9:00 pm—CLC Gymnasium

INTEGRITY AND LONGEVITY IN MINISTRY



Session 3 (Additional Notes)



New Individual Members

(As of June 10, 2026)

Ordination



Randall Ambuel
Dover Chapel
Glen Rock, PA



Will Brown
King of Glory Church/
Corporate Care
Garretson, SD



Karissa Costello
Family Worship Ctr.
Red Lion, PA



Timothy Drost
Kipton Community
Oberlin, OH



AnnMarie Faillace
Salt & Light
Community Church
Montegue, NJ



Emily Fisher
Faith@Work
Taiwan



Tyler Grantham
Cornerstone Church
Americus, GA



Tyler Krueger
House of Ancient
Faith
Cedar Rapids, IA



Anita Malizzi
Grace Unveiled
Birdsboro, PA



Curt Malizzi
Grace Unveiled
Birdsboro, PA



Jerry Stone
Grow Churches
Mainville, OH



Kim Wheeler
Souls Church
Clearwater, MN



Nathan Wheeler
Souls Church
Clearwater, MN

Upgrade to Ordination



Peter Belschwinder
Grace Chapel
Clifton Park, NY



Joel Jones
Harvestime
Outreach Church
New Richmond, WI



Angela Campbell
Hope Center
Tucker, GA



Tony Cucuzella
Family Worship Center
of Red Lion
York, PA



Will Heath
Florence Church
Wakeman, OH



Terri Warner
Legacy Ministries
Newman, GA



Cordelia Magwood
Angelica Church
Virginia Beach, VA



Duane Reeves
Morning Star Church
Wentzville, MO



Orlando Sanchez
Teen Challenge
Kingsville, TX

General License

New International Members, Church Members, and International Network

(As of June 10, 2026)

International Ordination



Mark Jayakumar
Rays of Peace
Karnataka, India



Dan Ombija
Hopewell Christian
Fellowship
Narok, Kenya



James Chemiati Samson
House of Hope
Fellowship
Nakuru, Kenya



Edward Wafula
Believers Disciple
Chapel
Nairobi, Kenya

New Member Churches



Freedom Community Church-Hopewell Twp.
Felton, PA



Brittney Morris



Thrive Church NJ - West Orange, NJ



Kobie & Melissa Morgan

New International Network

Integrity Partners Network
Sofia, Bulgaria



Radoslav Iliev

*We offer our sincere sympathies to all of those who have
lost loved ones in the past year.*



Dale Sísam



Tom Herbert

Session 4—Notes

Thursday, June 25—9:30-10:30 am—CLC Gymnasium

THE CALLING OF HARVEST NETWORK



Session 4 (Additional Notes)





Sandy Sisam

Session 5—Notes

Thursday, June 25—11:00-11:30 am—CLC Gymnasium

YOUR CALL—YOUR ANCHOR





Session 5—Notes

Thursday, June 25—11:30-12:00 pm—CLC Gymnasium

KEEP SAYING YES

Dr. Quincy D. Brown



About Harvest Network

Who We Are

Harvest Network is a Christian-ordaining body and network of individual ministers, congregations, and ministries connecting to equip God's workers and reach the world for Christ. We exist to provide not only the practicality of ministerial credentials but also spiritual covering, support, and networking and fellowship opportunities with ministers who walk similar paths.

Harvest Network holds a 501(c)(3) tax-exempt status with the federal government and is registered as a faith-based, non-profit corporation. Credentials issued by Harvest Network are recognized by federal and state authorities, hospitals, prisons, and Veterans Affairs organizations.

Harvest Network was formed in the mid-1980s when a group of Spirit-filled Christian leaders from various backgrounds saw the need for a ministerial association that embraced a high view of Scripture, the importance of the gifts of the Spirit being active in the Church today, and a vision of a worldwide harvest.

These three convictions—(1) the Word, (2) the Spirit, and (3) evangelism and missions—remain the foundational values for this association. Harvest Network has today grown to include strong congregations and ministries along with credentialed ministers in the U.S. and dynamic peer-networks overseas. These international networks oversee hundreds of churches and evangelists.



Our Purpose

Harvest Network exists to be: *A relational community that inspires, nurtures and equips ministry leaders to see God's will done on earth as in Heaven.*

Our Core Values are:

HEALTHY LEADERS WHO FINISH STRONG

We value long-term individual growth over numerical growth, committed to learning, coaching, partnering and praying together-so we finish healthy, fruitful, and strong.

I have fought the good fight, I have finished the race, I have kept the faith. (2 Timothy 4:7)

NURTURING AUTHENTIC RELATIONSHIPS

We value authentic relationships focused on friendship, encouragement, coaching, mentoring and networking for Christ's Kingdom purposes.

...encourage one another and build one another up, just as you also are doing. (1 Thessalonians 5:11)

INTENTIONAL DISCIPLESHIP & LEADERSHIP DEVELOPMENT

We value growing together as Jesus' disciples, committed to making other disciples grounded in the Word of God.

By this all people will know that you are My disciples; if you have love for one another. (John 13:34)

About Harvest Network (Continued)



MEET THE LEADERSHIP TEAM

Harvest Network is very blessed to have this capable leadership team to serve our network and help implement its' goals and mission.

FOR MORE INFORMATION:

harvestnetwork.live



Dale Sisam

HNI Network Director
dale@harvestnetwork.live



Kevin Brown

HNI Board Member
kevin@harvestnetwork.live



Dennis Calhoun

HNI Board Member
dennis@harvestnetwork.live



Tom Herbert

National Field Coordinator
tom@harvestnetwork.live



Kellie Fellenger

Member Services
office@harvestnetwork.live



Judy Herbert

Communications Coordinator
judy@harvestnetwork.live



The Harvest Network Logo

The Harvest Network logo symbolizes our partnership with God in producing a harvest of souls. For the past decade, we have used three connecting colored dots to represent the commitment all Harvest Network members share to fulfill Christ's Great Commission in a never-ending cycle of sowing, growing, and going in His name. The brown color represents the seed of the Gospel we sow around the world through evangelism. Moving clockwise, the green color represents our commitment to discipleship, teaching, and equipping all who have been made alive in Christ. The gold color represents a harvest of mature disciples who reinvest themselves in the call to spread the Good News of Christ's Kingdom to the ends of the earth.

[Jesus] said, "This is what the Kingdom of God is like. A man scatters seed on the ground. Night and day, whether he sleeps or gets up, the seed sprouts and grows, though he does not know how. And the soil produces grain—first the stalk, then the head, then the full kernel in the head. As soon as the grain is ripe, he puts the sickle to it, because the harvest has come". (Mark 4:26-29)

[Jesus] told them, "The harvest is plentiful, but the workers are few. Ask the Lord of the harvest, therefore, to send out workers into His harvest field". (Luke 10:2)

Contact Us

Email: office@harvestnetwork.live
Website: harvestnetwork.live
Phone: (651) 438-2596
Mail: P.O. Box 857, Delaware, OH 43015

Presiding Overseer: Dale Sisam, dale@harvestnetwork.live
National Field Director: Tom Herbert, tom@harvestnetwork.live
Member Services: Kellie Fellenger, office@harvestnetwork.live
Communications Director: Judy Herbert, judy@harvestnetwork.live

Regional Connection

GET CONNECTED REGIONALLY

CONNECT WITH YOUR REGIONAL LEADER



North Region
Kendra Diehl
 kjddiehl@gmail.com



Northeast Region
Joe & AnnMarie Faillace
 josephfaillace1126@gmail.com



Southeast Region
Tammy Melton
 tammy@legacyministries.info



Heartland Region
Jeremy & Elisha Robinson
 jrobinsoncs@gmail.com

As a respected member of the leadership core, Harvest Network Regional Team Leaders will work to ensure all member ministry leaders within each region are cared for, connected relationally and equipped for ministry. Each regional team leader has begun the process of developing regional teams.

UPCOMING

Events



2026 FALL REGIONAL GATHERINGS

MARKED FOR MORE: Pursuing the Call

*"I press on toward the goal for the prize of the upward call of God in Christ Jesus."
 (Philippians 3:14)*

SOUTHEAST - SEPTEMBER 17-29
 HISTORIC BANNING MILLS - WHITESBURG, GA

NORTH CENTRAL - OCTOBER 5-6
 HARVESTIME OUTREACH CHURCH - HUDSON, WI

HEARTLAND - OCTOBER 26-28
 BERLING GRANDE HOTEL - BERLIN, OH

NORTHEAST - NOVEMBER 4-6
 SALT & LIGHT CHURCH - MONTEGUE, NJ



USE THIS QR CODE TO REGISTER ONLINE FOR THE 2026 REGIONAL GATHERINGS

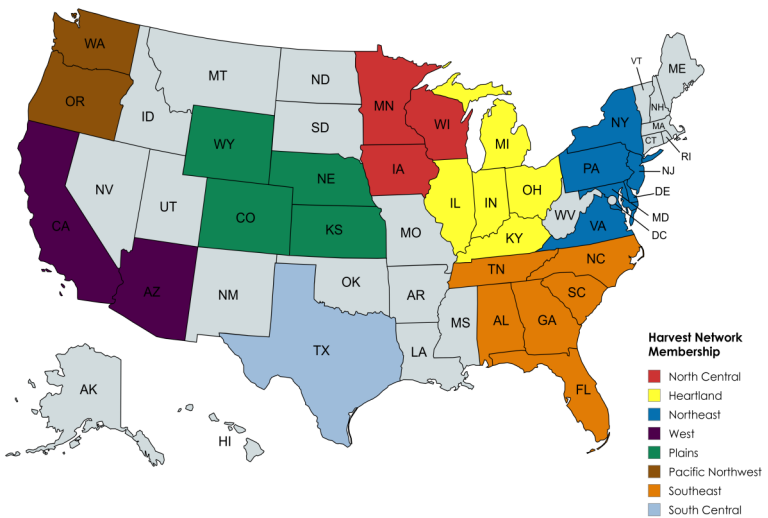



2027 Annual Assembly Early Registration

+ Online Registration Now Available

MENDED
Wholeness that Multiplies

JUNE 22-24, 2027
CHURCH OF THE GOOD SHEPHERD - WAYNE, OH

INDIVIDUAL RATE:

Super Early Bird Price:
\$125/person (thru March 1, 2027)

Early Bird Price:
\$150/person (thru April 15, 2027)

Regular Pre-Registration:
\$175/person (after April 15, 2027)

At the Door:
\$195/person



Early online registration is available for the 2027 Annual Assembly. Register at the HNI Resource Table.

Use this QR code when registering.

GROUP RATE

\$125/adult (thru April 15)
\$150/adult (April 16 thru June 1)

Groups of three or more from the same church or ministry.

Additional individuals may register in the group by June 1, 2027.

STUDENT RATE

\$70/student

11-17 years old.

CHILDREN

Infant to 10 years old.
For more information, please contact the office at (651) 438-2596.

2027 Annual Assembly - Early online registration now available

BOOK NOW!

Harvest Network Resources

Monthly eNewsletter

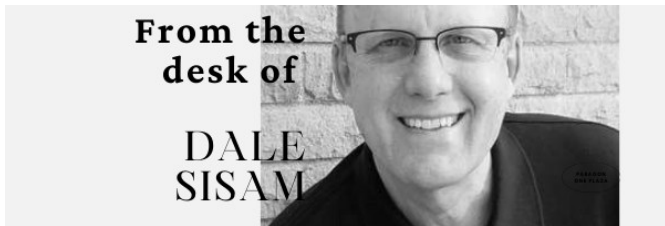

Stay up-to-date on the latest news through the HNI Monthly eNewsletter which are published the first day of each month. Inside each issue is a word from Dale, new members and member churches, network news, and more.

We'd love to hear from you! Please let us know what is going on in your ministry, or if you have any prayer requests that we could consider sharing in our upcoming Network News! section. The content will be subject to editing based on space. If you are planning a regional or annual event and would like us to advertise, please send us your promotional material in pdf format.

If you haven't been receiving the monthly eNewsletter, please send a request email to Tom Herbert at tom@harvestnetwork.live.

Membership



INDIVIDUAL MEMBERSHIP
Join the family of ministry leaders!

At our heart, we are a family that inspires, nurtures, and equips ministry leaders to reach God's world with His love and grace.

While offering ministerial credentials is at our core, we do so much more. As a national community, our commitment is to help equip and mentor leaders in their leadership development. We do this through offering various leadership training, resources, and support to growing leaders and those who mentor them. We want to be a part of your ministry journey.

We believe in the leadership of Christ. We are committed to excellence. Whether you are a church leader or just a servant who seeks to reach God's world, we want to be a part of your ministry journey. Join our growing family of ministry leaders.

HARVEST NETWORK
www.harvestnetwork.live | 412-438-2048 | membership@harvestnetwork.live

Harvest Network is a Christian ordaining network of individual ministers, congregations, and ministries who have united to more effectively equip God's servants and reach the world for Christ. We exist to provide ministry credentials, give supportive spiritual covering to individuals and churches, and continually provide up-to-dated growth and networking opportunities for our members. Visit the HNI Resource Table to pick up a membership flyer or visit our website and look under the Menu/Join for more information.

Website Resources

- Video resources of previous Annual Assemblies, Regional Gatherings, and Summits
- Monthly eNewsletters
- Books & Websites endorsed by Harvest Network
- Calendar of Events
- Directory of Churches and Para-Church Ministries

Harvest Network Website

HARVEST NETWORK

You can help us keep your information up-to-date. Simply go to: harvestnetwork.live.

Visit us online...



- On the home page, click "HARVEST MEMBER LOGIN".
- Then click "MEMBERS LOG IN—BREEZE DATABASE."
- From there you can edit and update your profile information.

To gain first-time access to the database, email office@harvestnetwork.live with your name and email address. You will soon receive an invitation to join and to access the database.

Magazine



The HNI Magazine is published twice a year as the Spring/Summer Edition or the Fall/Winter Edition. We aim to reach our members with the message of the theme for the Annual Assembly or the Regional Gathering. Inside this year's magazine you'll hear from our HNI members as they share about *CALLED*. Promotional material for the

Assembly and recommended reading on *CALLED* is threaded throughout. Look for the next Magazine which will be published in the fall with the focus on the upcoming Regional Gatherings. If you would like a copy of the recent magazine, visit the HNI Resource Table.

Higher Education Partnerships

- Regent University provides a 15% tuition discount.
- Masters Institute has a partnership with HNI as a non-traditional seminary option.
- Revive School waives the application fee.
- Great Awakening Bible Training Center has a partnership with HNI.



Harvest Network Resources (Continued)



RightNow Media

You can receive free access to a huge, streaming, online library of over 8,000 leadership videos. It's like the Netflix of Bible study videos. You will have FREE access to thousands of resources to help you with leadership, discipleship, evangelism, and more. The two categories you can use are the Leadership Events Library (conferences) and the Customizable Training Library (teachings).



OUR CHURCH'S BIBLE STUDY LIBRARY
**IS NOW DIGITAL...
 AND
 GIGANTIC.**
 OVER 18,000 DISCIPLESHIP VIDEOS
 FOR KIDS YOUTH AND ADULTS
 Download the app: android iOS ROKU Apple TV

www.rightnowmedia.org

How to Join

- Email Kellie Fellenger at: office@harvestnetwork.live
- Kellie will send you an email invitation to join RightNow Media. Follow the prompts.

How to Access the Media

- In your browser, type rightnowmedia.org.
- Log-in using your email and password provided.

Facebook

Like us on Facebook under Harvest Network. You can also join the Harvest Network Members Group. Members share posts of personal and ministry news, along with current Harvest Network information.



HNI App

Check out our new Harvest Network App. Download today! My Harvest Network

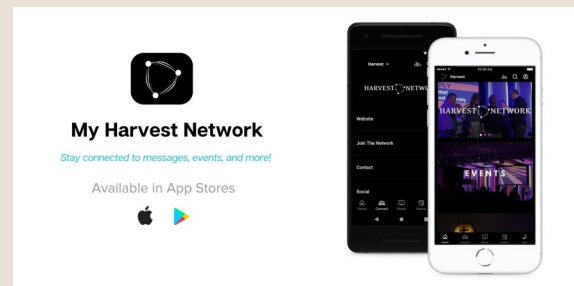

Harvest Network TV



Harvest Network Resources (Continued)

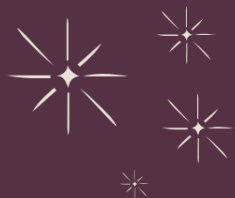

Leadership

PIPELINE

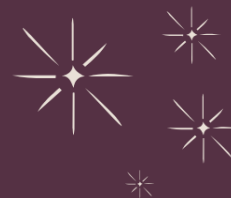

Help Wanted! We are looking for members of HNI to assist with some important areas in the Leadership Pipeline. We need volunteer help in areas including:

Social Media

Recruiting Team

Online Cohorts

App Management

Care Team

International Missions

If you are interested in serving, please contact Dale Sisam.

Download the app
and set up your own
personal profile

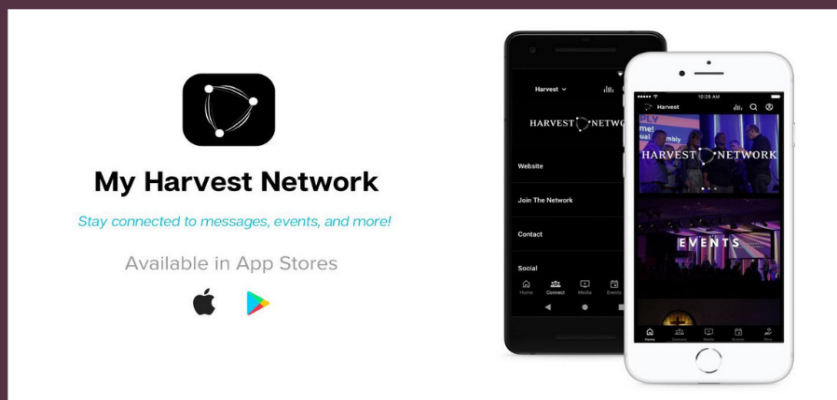

New Features Being Released This Week!

- New messaging channels allow our HNI community to stay better connected.
- Share prayer requests in real time on the app.
- Communicate with old friends and new via the messaging features.
- Stay in the loop with your online cohort through the app.
- and so much more....

Harvest Network Training

CHURCH PLANTING ESSENTIALS

August 14-15, 8a - 5p

- Organize, refine and pinpoint your vision, purpose, strategies and timeline early, so that you have a clear plan for the future.
- Use the 12 Biblical principles for church planting in everything you do.
- Recognize and avoid land mines such as launching too soon, choosing the wrong facility, or exhausting your launch team.

Location

Rock City Church
4311 Anson Drive
Hilliard, Ohio 43026

Cost

\$50
Includes lunch, snacks, and
beverages for both days.



SPONSORS:

HARVEST NETWORK

growchurches dcpi

FALL 2026 ONLINE COHORT

September 3-October 22 - Thursday Nights, 6:30-8:00 pm EST

Facilitator: Dr. Quincy D. Brown, Senior Pastor, Snellville Community Church, Snellville, GA



An online coaching cohort for faith leaders navigating irreversible change

Scripture shows that God often leads His people through seasons of transition that reshape leaders before they reshape ministries.

Roundabout Renewal is an 8-week coaching cohort for pastors, missionaries, counselors, nonprofit leaders, and other faith-based leaders navigating transition.

Using the biblical movements of Egypt, the Red Sea, the Wilderness, Jordan River, and the Promised Land, this cohort provides a guided process for discerning where you are and how to lead faithfully through change.



HARVEST NETWORK

MINISTRY TRAINING SCHOOL PARTNERSHIPS

Equipped for the worldwide harvest



REVIVE SCHOOL



For more information, go to
harvestnetwork.live/our-partnerships

Financials (As of April 2026)

Harvest Network International

Financial Dashboard — Fiscal Year 2025–2026 vs. 2024–2025

Total income 2025–26
\$155,679
 vs \$156,389 prior year

Total expenses 2025–26
\$176,442
 vs \$162,746 prior year

General fund net
-\$20,762
 vs -\$6,357 prior year

Total assets
\$131,355
 vs \$157,180 prior year

Income sources — 2025–26

Member churches' 2% Member dues Events App fees & interest Individual gifts

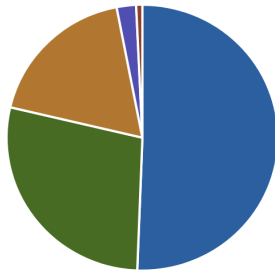

Expenses by category — both years

2025–26 2024–25

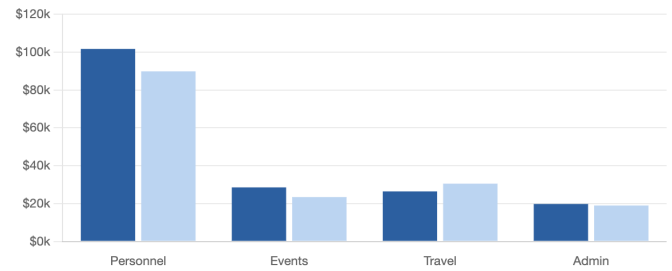

Income vs. expenses — year over year

Income Expenses

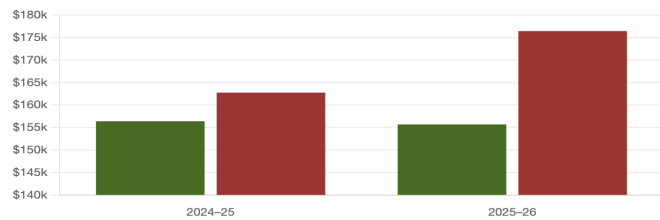

Balance sheet composition — both years

General fund Designated funds Liabilities Equity

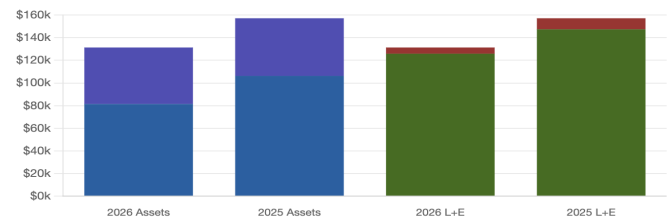

Designated fund ending balances — both years

2025–26 2024–25

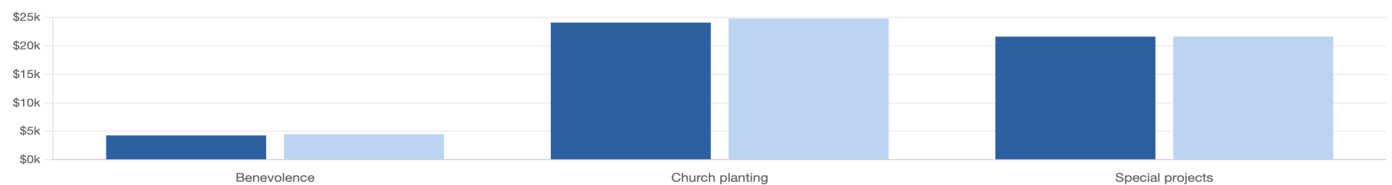

Harvest Network International | For detailed reports contact office@harvestnetwork.live or 651-438-2596

Local Sites

EXPLORE SOME DESTINATIONS!

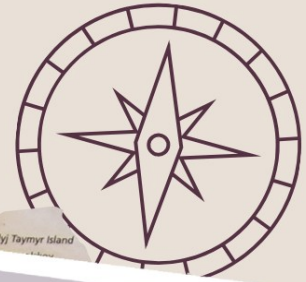

STONE MOUNTAIN PARK

1000 Robert E. Lee Blvd., Stone Mountain, GA 30083
stonemountainpark.com

Hours Every day, 5a-12a

About

Stone Mountain Park features outdoor recreational activities & seasonal family-friendly attractions. Only minutes from downtown Atlanta, explore our breathtaking natural and historical areas year-round.



MEDIEVAL TIMES DINNER & TOURNAMENT

5900 Sugarloaf Parkway, Lawrenceville, GA 30043
 (770) 225-0230 / medievaltimes.com/atlanta

Hours Show times vary. Check website.

General Admission Pricing

Adult (Age 11 and up): \$74.95 / Child (Age 10 and under): \$46.95



SOUTHEASTERN RAILWAY MUSEUM

3595 Buford Hwy., Duluth, GA 30096
train-museum.org

Museum Hours Thursday-Sunday, 10a-5p

General Admission Pricing

Adult: (\$19) / Seniors (65+): \$16 / Students (13-21 with ID): \$16
 Children (ages 2-12): \$13 / Extra Train Rides: \$4



Local Restaurants in Snellville, GA

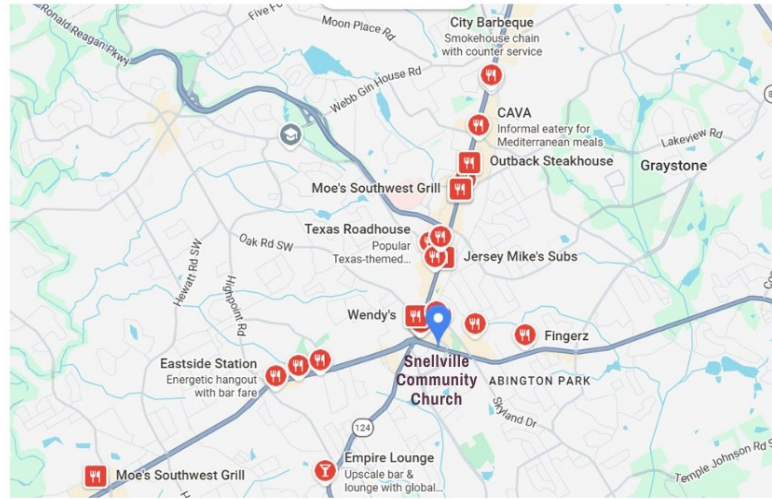

Restaurants near
Snellville Community Church

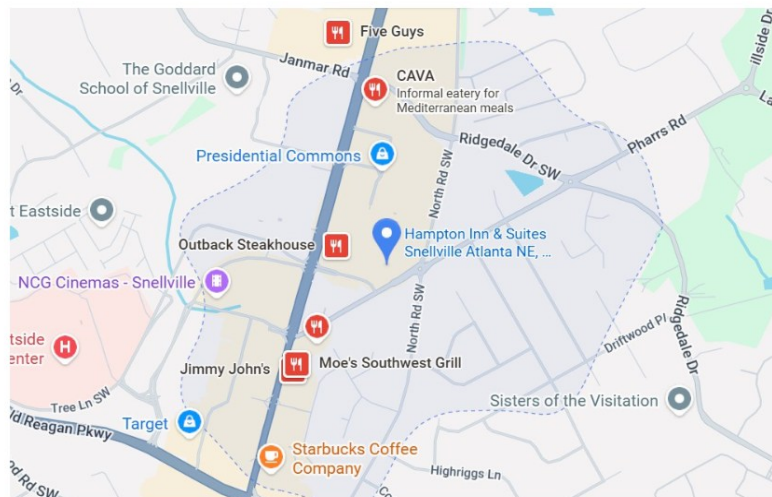

Restaurants near
The Hampton Inn

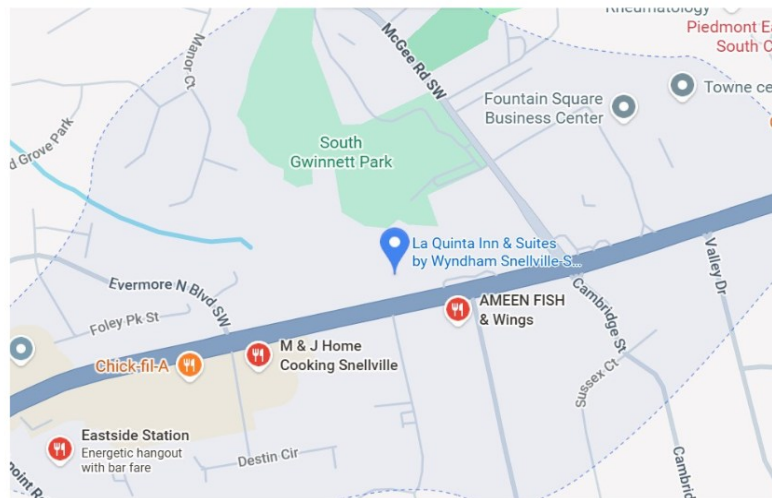

Restaurants near
the LaQuinta Inn

Facility Maps

(Annual Assembly Online Survey—We want to hear from you!)

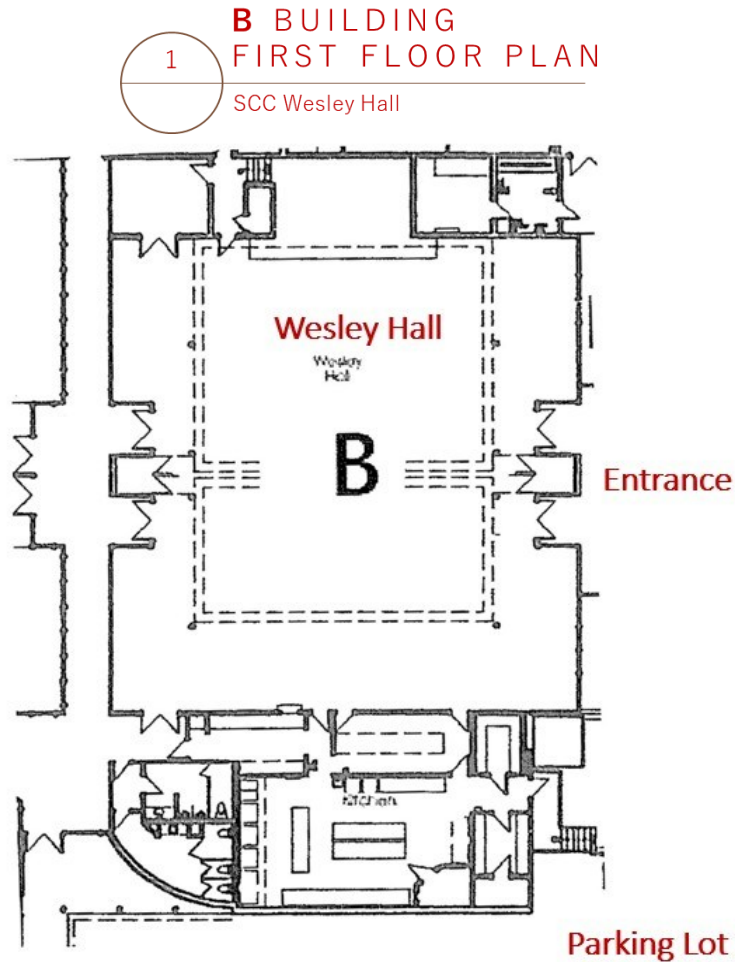

Annual Assembly Online Survey

Use this QR code to
access the online survey.



Annual Assembly Guide

General Sessions
Gymnasium

Workshops
Rm 207, Rm 209, Rm 210/211, Rm 317, Rm 318, Rm 319

Scheduled Prayer Appointments
Rm 113, Rm 114, Rm 229

Green Room
Rm 212

1 **C BUILDING**
FIRST FLOOR
SCC Christian Life
Center

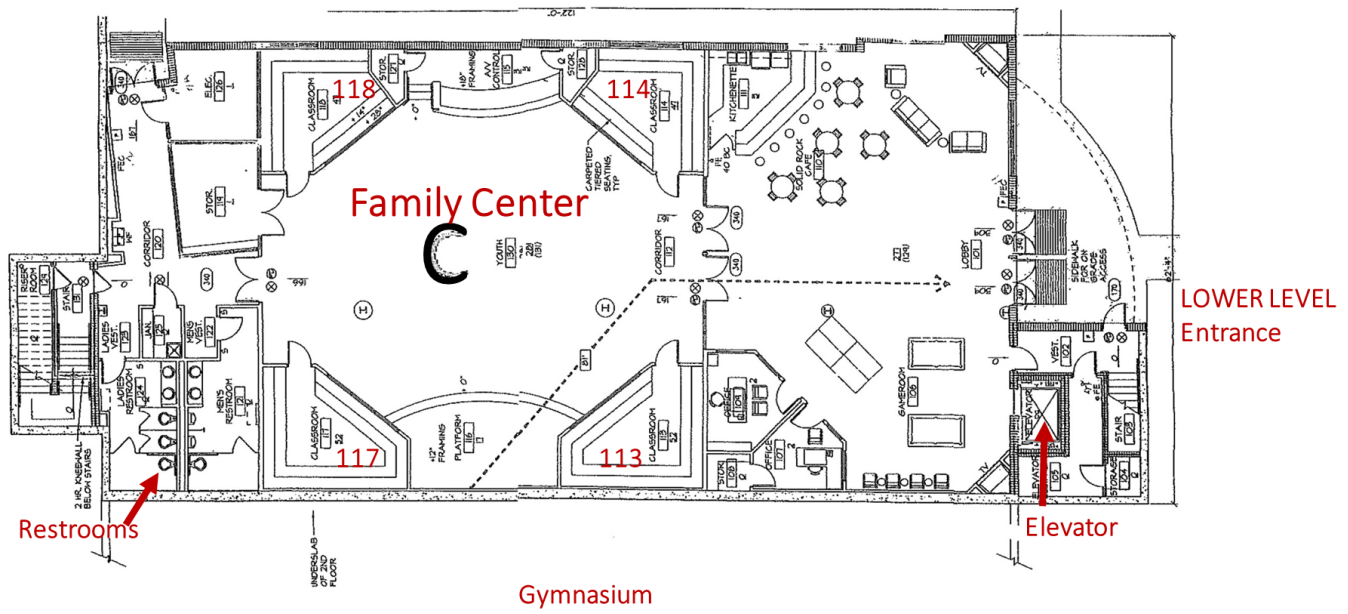

2 **C BUILDING**
SECOND FLOOR
SCC Christian Life Center

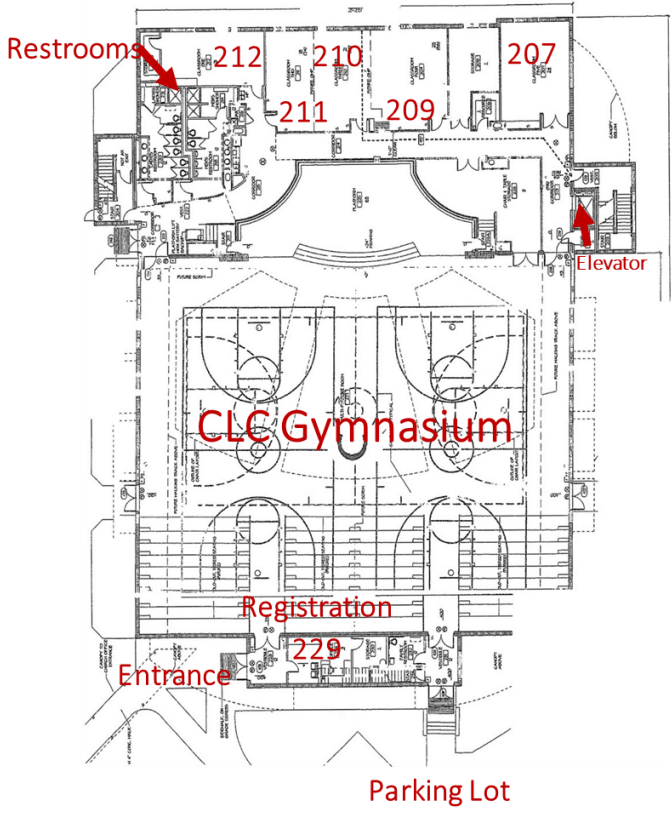

3 **C BUILDING**
THIRD FLOOR
SCC Christian Life Center

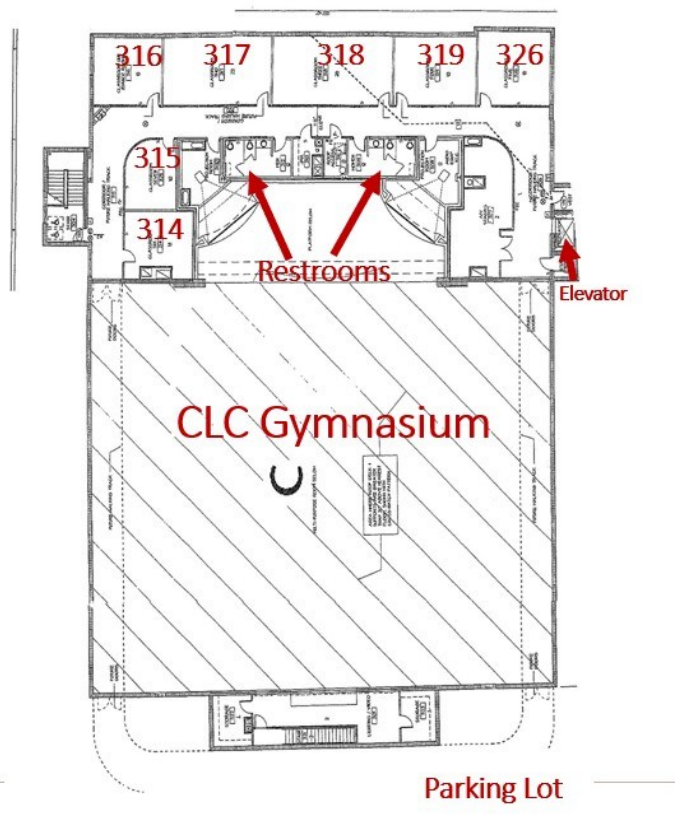

Assembly Schedule

TUESDAY June 23

6:00-7:00 pm
Assembly Registration
(Front – CLC Gymnasium)

7:00-8:45 pm
SESSION 1
Crawford Loritts
(CLC Gymnasium)

8:45 pm
Body Ministry
(CLC Gymnasium)
Connect Time
(Building B – Wesley Hall)

WEDNESDAY June 24

8:30-9:00 am
Worship & Prayer
(CLC Gymnasium)
Connect Time
(Building B – Wesley Hall)

9:00-9:30 am
Worship
(CLC Gymnasium)

9:30-10:30 am
SESSION 2
Dale Sisam
Jerry & Melanie Stone
(CLC Gymnasium)

10:30-11:00 am
Break

11:00-12:00 pm
WORKSHOPS
(Rm 207, Rm 209, Rm 210/211,
Rm 317, Rm 318, Rm 319)

12:30-2:30 pm
Prayer Appointments
(Rm 113, Rm 114, Rm 229)

12:00-1:30 pm
Lunch Break
(Building B – Wesley Hall)

1:30-2:30 pm
WORKSHOPS
(Rm 207, Rm 209, Rm 210/211,
Rm 317, Rm 318, Rm 319)

2:30-7:00 pm
Break

7:00-8:45 pm
SESSION 3
Crawford Loritts
(CLC Gymnasium)

8:40-9:00 pm
Commissioning of New
Members & New Member
Churches
(CLC Gymnasium)

9:00 pm
Body Ministry
(CLC Gymnasium)
Connect Time
(Building B – Wesley Hall)

THURSDAY June 25

8:30-9:00 am
Worship & Prayer
(CLC Gymnasium)
Connect Time
(Building B – Wesley Hall)

9:00-9:30 am
Worship
(CLC Gymnasium)

9:30-10:30 am
SESSION 4
Dale Sisam &
Tom Herbert
(CLC Gymnasium)

10:30-11:00 am
Break

11:00-12:00 pm
SESSION 5
Sandy Sisam
Dr. Quincy D. Brown
(CLC Gymnasium)

12:00-12:30 pm
Commissioning,
Communion, & Closing
(CLC Gymnasium)

12:30 pm
Post Assembly Lunch
(Building B – Wesley Hall)