



Worship

Livestream via our Website!

We have moved our livestream focus from our YouTube channel to our [website](#).

There is still a chatroom feature (when logged into your account - the same as the app account!) that we will monitor, just as we did on YouTube. Join us in the new [livestream space](#) this Sunday!

Pet Blessing: THIS Sunday!

Sunday, October 2nd
12:30pm - 1:30pm (Asbury UMC courtyard)
2pm - 3pm (Heritage Estates gazebo)

Asbury is offering a drop-in pet blessing on Sunday, October 2 in our courtyard! Bring your pet, visit with other pet owners, and have your pet blessed. All pets are welcome: dogs, cats, chickens, bunnies...the list goes on!

Spread the word to your neighbors and friends! There will be snacks both for pets and their humans!

Asbury Tech Updates

Our new technology is live!

The [website](#) has a fresh look, complete with new capabilities; we have an app that has all Sunday worship resources and keeps us connected; and a new giving platform on both the [website](#) and in the app!

As you are exploring the website and the app, please contact [Alaina](#) if you come across content that is incorrect/outdated/missing, or if there is a link that does not work.

Download the App & Create an Account!

We have our own app! Download it from your phone's app store by searching for "Asbury Livermore." Once you have downloaded it, create your account!

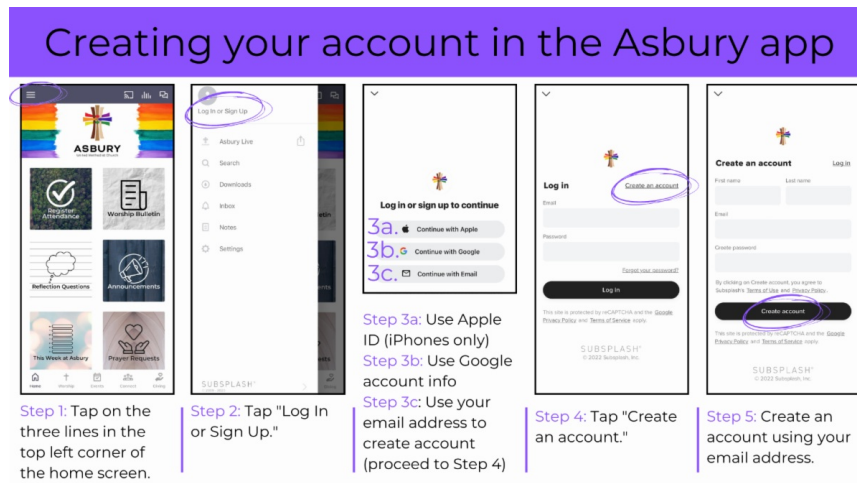

WHY you should create an account

- You'll be able to send and receive messages within the app with other Asbury folks who have an account.
- You can set up online giving for donations or if you need to pay for an event, item, or service.
- You'll (hopefully, eventually) be able to register your attendance at worship with a single tap!
- **Note:** if you don't plan on using the online giving/payment system, you do not have to connect a credit/debit card to your account

How to create your account:

1. Open the Asbury app and tap on the icon with three lines in the top left corner
2. Tap "Log In or Sign Up."
3. Choose which method you want to use to create your account.
 - 3a. "Continue with Apple" - use your Apple ID (iPhones only), then you're done!
 - 3b. "Continue with Google" - use your Google account info, then you're done!
 - 3c. "Continue with Email" - use your email address to create an account, then proceed to Step 4
4. Tap "Create an account."
5. Enter your name, email address, and create a password. Then tap "Create account" and you're done!

Join the Asbury A/V Team!

The A/V Team at Asbury is looking for more volunteers for Sunday. We need more people to add into our monthly rotation for Sunday morning worship. You will learn to run the sound board and/or the cameras for the livestream and volunteer once a month. No experience is necessary as we will train you on what you are interested in doing!

This is a great way to serve out church by helping to facilitate worship for our online community, and after a lot of great work this past summer, we have made working in the booth easier than ever! Additionally, we do many extra events throughout the year like forums, weddings, and funerals. Once trained and in the volunteer rotation, you will be able to sign up for these events and get paid! This would be a great opportunity for youth in our church.

If you are interested in volunteering, please reach out to [Pastor Brad](#).

Upcoming Asbury Events

Group Spiritual Direction

Wednesdays in October

October 5, 12, 19, 26

1:00pm - 2:30pm

Group size: 6-8 people

What is Group Spiritual Direction? It's another way of saying group spiritual friendship! This is an opportunity to give and receive one of the most precious and powerful gifts -- really being heard and to listen with quiet, fully present attention.

We all have a story and Covid has impacted us in different and (too often) traumatic ways. We will have an opportunity to experience how God shows up differently for each of us. There is no fixing or problem solving but being together and sharing in a safe, confidential, and sometimes silent atmosphere.

This group will be facilitated by Barbara Ernest, who has been practicing as a Spiritual Director for over 30 years and is ready to offer the group experience again after COVID. For more information or to sign up contact [Barbara](#).

Celebration of Life

Brigitte Gim

Thursday, September 29th at 1:00 pm

Callaghan Mortuary

Gifts in her memory can go to Open Heart Kitchen or Hope Hospice.

Val Pace

Friday, October 7th at 4:30 pm

Asbury UMC

Juanita Benson

Saturday, October 8th at 2pm

Asbury UMC

Reception to follow

Asbury Follies is back!

Saturday, October 15th
7:00pm

Asbury Follies, is a fun-filled evening full of songs, skits, jokes, dances, juggling, magic --- you name it!

Start thinking about what you'd like to do for this year's follies, and contact [Martie Muldoon](#) with your ideas, comments or questions. If you'd like to participate, but don't know what to do, you can still sign up! All ages are welcome!

And we need audience members, too, so save the date for a wonderful evening of fun!

United Women in Faith Gathering



Saturday, October 15th

The California-Nevada Conference United Women in Faith (formerly United Methodist Women) are coming to Asbury for their annual meeting. There will be 80 to 100 women in attendance.

Because our UWF group has not been active since the start of the pandemic, we are asking all women of Asbury to be hosts. We need greeters, set up, help in the kitchen for the morning brunch and lunch, bakers and cleanup help.

Nancy Grover will be coordinating the lunch. [Lorraine Magee](#) and [Burlyne Wilson](#) will be coordinating the other aspects. Please let us know if you can help in any of these special ways. The district loves meeting here and we wish to be great hosts.

Upcoming Community Events

Red Cross Blood Drive

Friday, September 30th
12pm - 6:00pm
Asbury UMC Fellowship Hall

Share your good health by giving blood or platelets. Donating blood could save a life. To schedule your appointment, visit redcross.org to check appointment times and sign up or call 800-733-2767. When scheduling, enter Sponsor Code: ASBURY925.

Please sign up to donate today. Invite a friend, too!

Fertile Groundworks Farewell to Summer Garden Party Fundraiser

Saturday, October 1st
4:00pm - 7:00pm
Asbury UMC Courtyard

The silent auction will begin right at 4pm and will remain open until 6pm. Announcement of the winners along with prized live auction item will take place at 6:30pm. Don't miss your chance to nab your favorite item!

Also, come to enjoy the delicious outdoor dinner and tasting in the beautiful sheltered and shady Asbury courtyard. We'll have music, games, Master Gardener Ask-Me-Anything booth, and tours of the garden going on all afternoon!

Tickets are \$30 for adults and \$10 for children. Space is running out as we are capping at our first 100 guests! Reserve your spot [here](#).

Virtual Early Response Team Training

Saturday, November 5th & Sunday, November 6th
1pm-5pm

Cost: \$15 per person for ERT class. \$41 for Safe Gatherings online background check and Abuse Prevention Training (to be paid on the Safe Gatherings website)

Instructor: Leslie Carmichael

Training includes: ERT training manual, ID badge, lanyard and t-shirt

The Mission of an Early Response Team (ERT) is to provide a caring Christian presence in the aftermath of a disaster. The team is not a "first response" group; nor is it a recovery, rebuild or repair team. It is assigned various tasks; usually relating to safety, mitigation of further damage to property, and cleanup tasks to assist the homeowner in preparation for rebuild. Register [here](#)!

Asbury Community

Souped-Up Spiritual Growth Group

The Souped-Up Spiritual Growth Group is beginning a new study starting Wednesday, October 12!

We will be reading and discussing *You Are the Happiness You Seek: Uncovering the Awareness of Being*, by Rupert Spira. In this book, Spira discusses our innate longing for peace and happiness and walks us on a journey inward to find it. This is a 20-week study. The

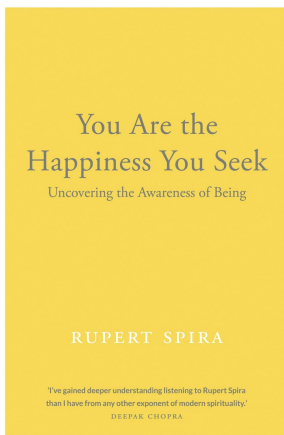

reimbursement amount for the book is \$22.

We meet on Wednesdays, from 6-8:30 p.m. (supper included), and we have room for three more people around the table. Please email [Sharmyn Crawford](#) with any questions and/or to sign up. We have a book waiting just for you!

Tiny Homes at Asbury: Update

On Sunday, September 11, after worship, the congregation gathered to hear what the Tiny Homes Task Force has been working on since January. A recording of this event will eventually be posted on the Asbury website, so watch for the announcement in a future e-article. When it is available, we encourage you to view it there if you were unable to attend, or even if you just want to hear it again.

There are, of course, many more questions than answers at this stage. Lots of study and research remain to be done. Here, however, are a few of the highlights of what we know so far.

1. There is a real need for housing the unsheltered in our area. As of the 2022 point-in-time count of the unsheltered in Alameda County (delayed three years because of Covid) there were 7,135 homeless people in Alameda County, 174 of them in Livermore. This number continues to grow every year.
2. Asbury is blessed with having ample unused land behind the Fertile Groundworks gardens and the community gardens, which gives us the unique opportunity to provide the space for tiny homes. The land is zoned for residential use.
3. Creating housing for the unsheltered very much aligns with Asbury's core values: being centered in Jesus Christ, we grow in faith, we celebrate community, and we serve others with love. It will take faith to undertake such a large and complex project; along with our partnering social service agency, we will strive to create a safe, stable, supportive community for the residents of the tiny homes; and of course, we will serve them with love and kindness, not judgment and barriers to healing.
4. A housing model that has proved highly successful in helping the unsheltered transition away from the streets for the long term is called "Housing First." Once in permanent supportive housing, people can better address their other needs, e.g. reconnecting with family, getting medical help, and working on education and job goals.
5. The City, District Superintendent and a local service agency (La Familia) have encouraged us to continue exploring the concept of building tiny homes at Asbury.

6. If this use of the land is approved by the Cal-Nev Conference Cabinet, the approval of the congregation will then be sought in an all-member vote. If approved the plan will then go to the regional body for approval, since the land belongs to the Annual Conference, not to Asbury.

There will be other educational events be presented in the future and the Tiny Homes Task Force will keep everyone updated with articles in the digital newsletter, announcements in worship, etc.

Finally, THANK YOU for your patience and encouragement during this fact-finding process.

Asbury Capital Campaign Envelopes

If you have Capital Campaign Envelopes that you are not using, please return them to the church office or mailbox in the driveway. Contact the [church office](#) if you have any questions.

Asbury Masking Policy

Asbury follows the guidance of the Alameda County Public Health Department (ACPHD) regarding indoor masking. **Currently masks are highly recommended but not required.** Sunday School teachers and nursery staff will continue to wear masks when children less than 5 years old are present indoors. We encourage everyone who is able to get vaccinated and boosted.

Sunday Prayer Requests

Please pray for the [requests](#) that were made during prayer time on Sunday.

If you would like to be on the email prayer chain, please contact the [church office](#).



Events at a Glance

RECURRING EVENTS

- Every Sunday; 10am: Asbury worship service
- Check out our [small groups](#)! Email the [church office](#) for more info, including links for virtual groups.

SEPTEMBER

- Sun, Sept 25; 12:30pm: Church Council meeting
- Thurs, Sept 29; 1pm: Brigitte Gim Celebration of Life
- Fri, Sept 30; 12-6pm: Red Cross Blood Drive

OCTOBER

- Sat, Oct 1; 4pm: Fertile GroundWorks fundraiser
- Sun, Oct 2; 12:30-1:30pm: Pet Blessing (at Asbury)
- Sun, Oct 2; 2-3pm: Pet Blessing (at Heritage Estates)

- Fri, Oct 7; 4:30pm: Val Pace Celebration of Life
- Sat, Oct 8; 2pm: Juanita Benson Celebration of Life
- Sat, Oct 15: United Women in Faith conference-wide gathering
- Sat, Oct 15; 7pm: Asbury Follies
- Sun, Oct 30; 3-5pm: Trick or Treat Fun & Games

NOVEMBER

- Sat-Sun, Nov 5-6; 1-5pm: Virtual ERT Training

Have questions?

Reply to this email or call the office at 925-447-1950.

Have an article, announcement, or event to submit?

Send them to the [Alaina Harrison](#), our Communications Specialist,
by 3pm on Tuesdays.

Miss a newsletter or need to go back and re-read?

Check out the [newsletter archive](#)!

Asbury United Methodist Church | 4743 East Avenue, Livermore, CA 94550

[Unsubscribe](#) terrig@asburylive.org

[Update Profile](#) | [Constant Contact Data](#)
[Notice](#)

Sent by office@asburylive.org powered by



Try email marketing for free today!